

ARTWORK SHOULD FIT THIS SIZE

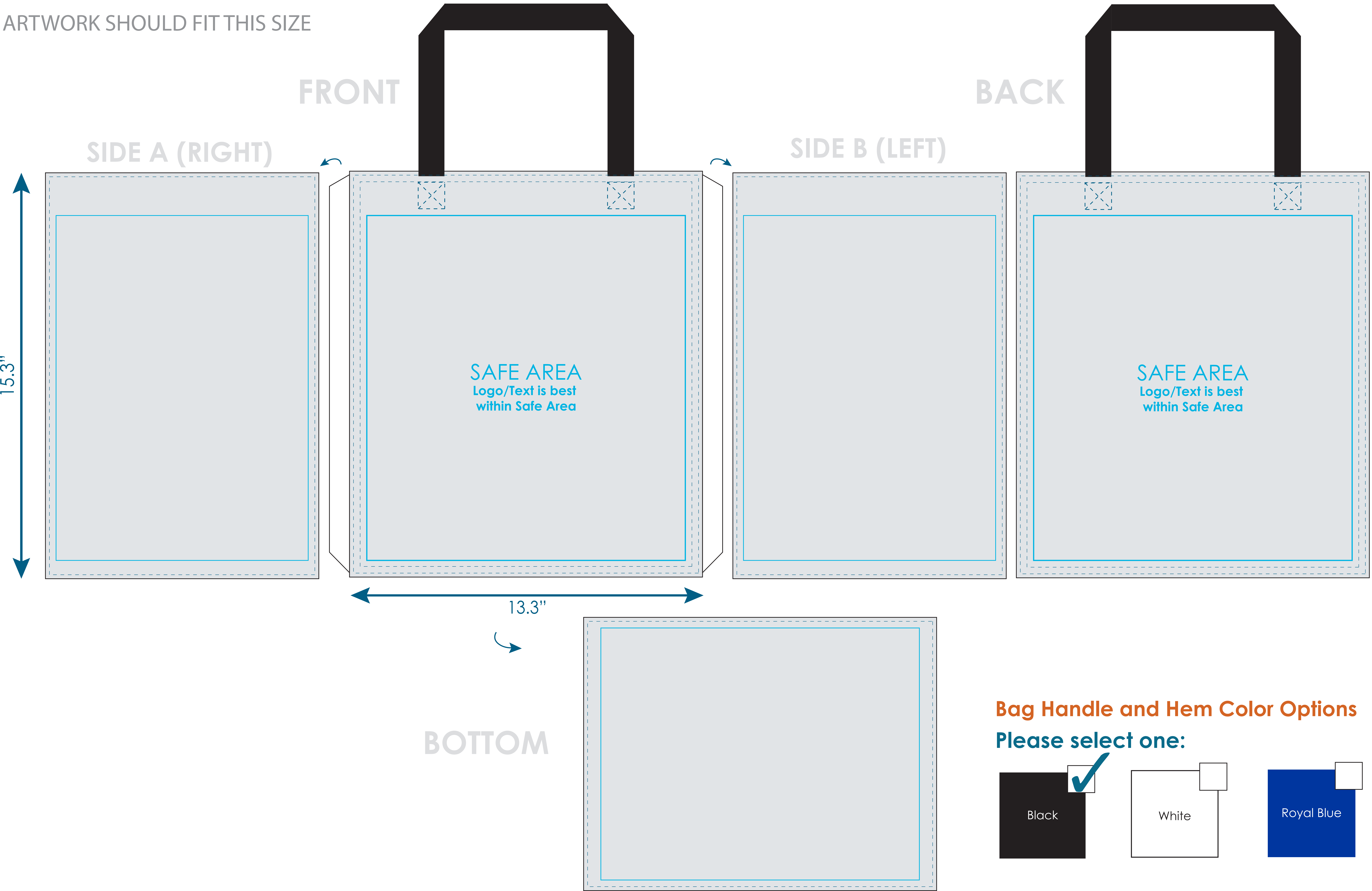

Basics+ 13"x 15"x 10" Laminated 5-Panel PP Non-Woven Tote Bag

BSC026

Final product size approx. : 13"x 15"x 10" (W x H x D)

Imprint size - Front and Back : 13.3"x 15.3" (W x H)

Sides : 10.3"x 15.3" (W x H) **Bottom :** 13.3"x 10.3" (W x H)

Front and Back safe area size: 12"x 13" (W x H)

Important Product Notices

Keep text and important images within the safe area.

Supplied Artwork: Submit print ready artwork in vector format. Accepted file types are AI, EPS, PDF. All text must be outlined. All placed images MUST be at least 300ppi. All customer-submitted artwork must be sized at 100%.

Font sizes less than 12pt may not print legibly.

Art files must be saved at sizes:

Front and Back : 13.3"x 15.3" (W x H)

Sides : 10.3"x 15.3" (W x H)

Bottom : 13.3"x 10.3" (W x H)

Bag Handle and Hem Color Options Please select one:

